

QUICK RELEASE SCOOTER SEAT INSTALLATION INSTRUCTIONS

If you have ever had an occasion to remove the seat on a motor scooter, you know it can be a frustrating and challenging experience! Most shops will charge an hours labor just to remove and install the seat. In the real world, that's about a hundred dollars! To work on the engine, carburetor filters or other related components, the seat **has to** be removed first.

There are (usually) four 10mm nuts on the bottom front of the seat must be removed, then the bracket that the seat attaches to. I have two scooters with two or three of these small nuts lost down in the internal workings of the engine. They are difficult at best to get off and you have to use a 10mm open end wrench to get at them. Then, try to get the seat on again!

Well, here's a device that will have that seat off and back on again in 10 seconds! It's a spring loaded shot bolt that can be installed in about 20 minutes once the seats off. You'll need a power drill & ½" bit, a Phillips screwdriver & a 10mm & adjustable wrench. Here's how:



Figure 1

Open the fuel door and remove the two screws shown.

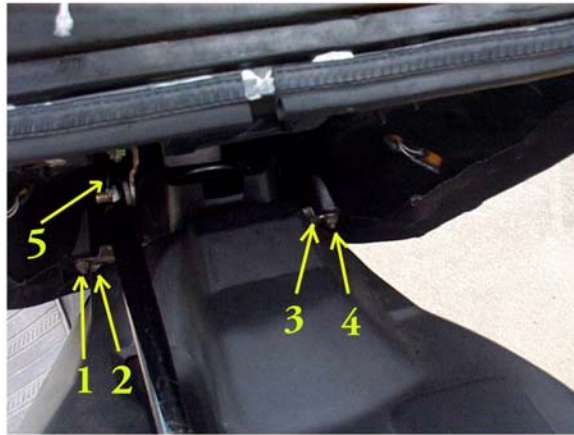

Figure 2

Remove the four 10MM nuts and spring clip (5).



Figure 3

Lift off seat and remove the 2 bolts (1) on both sides of the bike. The entire bracket (2) will now come off.

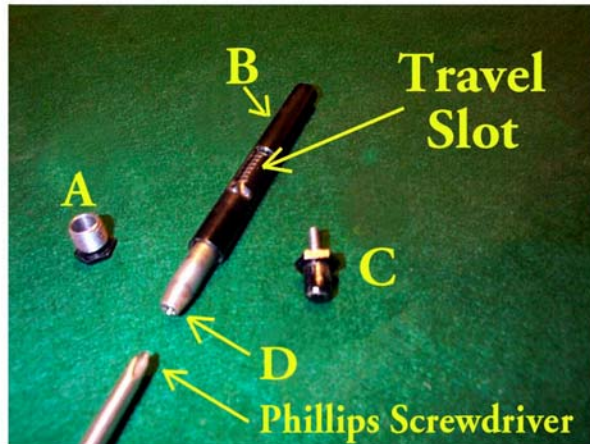

Figure 4

The entire shot bolt assembly consists of 4 parts:
A – The Guide Stud C – The Ball Stud
B – The Body Assembly D – The Shot Bolt
(Yeah, there's a spring in there too!)

Flip your seat over and bolt the bracket you removed (Fig 3-2) back onto the seat using the four 10mm nuts.

Tip: DON'T install it upside down! Now, replace the two screws shown in Figure 1, screw them into bracket 2 again. Disassemble the assembly (Fig. 4) leaving the shot bolt (Fig 4-D) in place.

Insert your Phillips screwdriver into the the end of the shot bolt (Fig 4-D), push the shot bolt all the way in and twist it slightly to the right. I will stay in place there. The bolt is now retracted and ready to install.



Figure 5

On the **RIGHT HAND SIDE OF THE BIKE ONLY**, Mark the plastic cowling with a pencil at the approximate center of the bracket shown in Figure 5-1. This hole will go through the cowl and then through the bracket (2) and eliminate the welded in 10MM nut welded to inside of the bracket. **DO NOT DRILL OUT THE LEFT SIDE (X)**

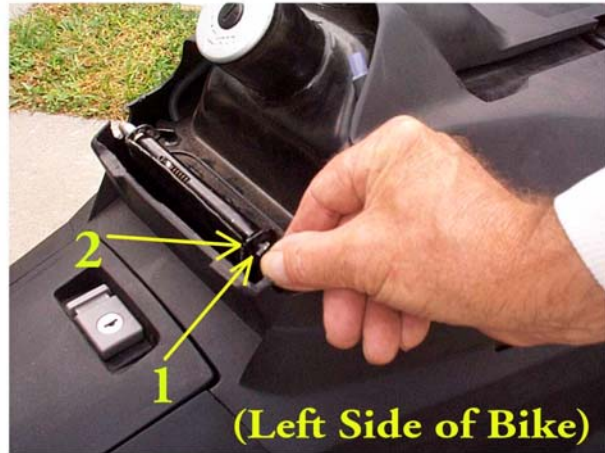

Figure 6

File or grind off any burrs and drop in the Body Assembly (Fig 4-B) Keep the small hole to the left side of the bike. **TIP:** Release the shot bolt to help align. Screw Ball Stud (Fig 4-C) through the bracket (1) and the 10mm nut still in place here (2), then into the Body Assembly (Fig 4-B) Again, having the shot bolt “released” will maintain your alignment. Finger tight for now is fine.

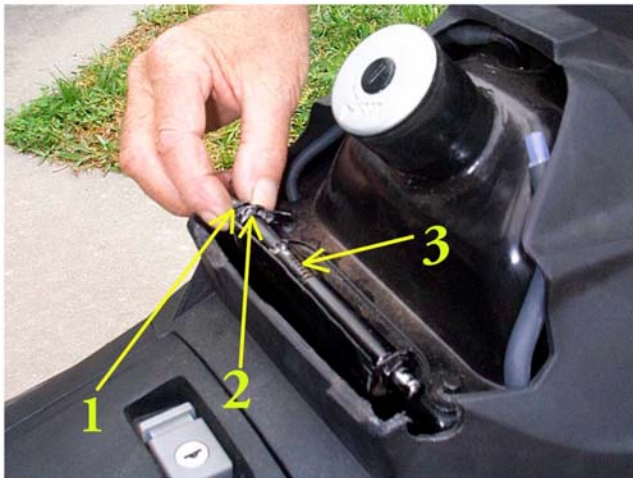

Figure 7

On the **RIGHT SIDE** of bike, screw the Guide Stud (1) - refer to (Fig4-A) through the drilled hole (2) and into Body assembly. **Tip:** “Pop” out the shot bolt, it’ll be easier to align. **Make sure travel slot (3) - (refer to Fig 4) is “up”.**

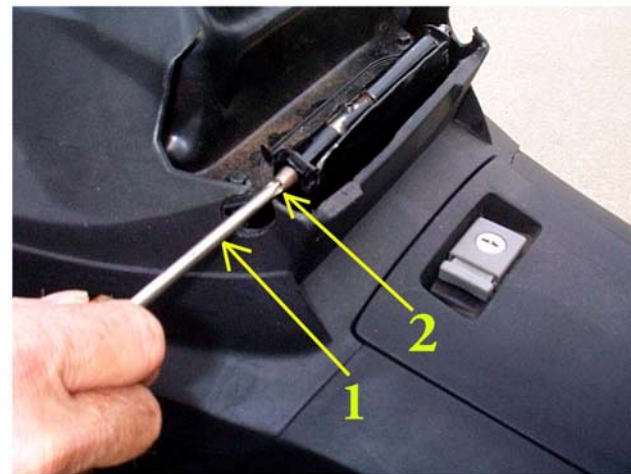

Figure 8

Tighten both the studs with your 15MM or adjustable wrench. A drop or two of oil in the travel slot helps. Now, check for proper operation, make sure the shot bolt extends and retracts all the way and locks a couple times.

If you encounter difficulty inserting the Body Assembly between the existing brackets on the bike, you can easily bend the brackets in or out until it drops in. Remember to keep the Travel Slot on the Body Assembly “up” when tightening studs.

To remove the seat from now on, pop the pin out of the air cylinder, stick your Phillips screwdriver into the hole (Fig 8-1), push it all the way in and turn the shot bolt slightly to the right until it locks. That’s it! Lift off the seat and pocket that \$100. that shop would have charged. **Make SURE the shot bolt (Fig 4-D) is engaged in the seat hole (Fig 3-1) when installed!**

If you do take your bike to a scooter shop, don’t forget to tell them about this feature! They will then start buying and installing my device and I may be able to retire and live in the lap of luxury from then on! Thanks!

Ed Holdgate
31 Bohemia Circle
Clearwater, Florida 33767
Phone: 727 447 8387